

NOTE: DO NOT DISCARD the Parts List from the Instruction Bulletin. Place the Parts List in the appropriate place in the machine manual for future reference. Retaining the Parts List will make it easier to reorder individual parts and will save the cost of ordering an entire kit.

NOTE: Numbers in parenthesis () are reference numbers for parts listed in Bill of Materials.

Installation instructions for **kit number 9003283**

SYNOPSIS:

This kit contains the parts needed to install a seat lift kit onto M20/T20 machines.
 Please follow step-by-step instructions.

SPECIAL TOOLS / CONSIDERATIONS: NONE

(Estimated time to complete: 1 hour)

**PREPARATION:
 (Refer to FIG. 1)**

1. Park the machine on a clean level surface, turn off the machine, remove the key, and set the parking brake.

FOR SAFETY: Before leaving or servicing machine, stop on level surface, set the parking brake, turn off the machine, and remove the key.

2. Open the seat shroud and lift and lock the operator seat open.

INSTALLATION:

1. Drill two 11/32" through the front of the seat support panel and the insulation behind the support panel. Refer to Fig. 5.

2. Hold a mounting bracket (1) against the insulation behind the seat support panel (where the two holes are drilled through the insulation) and cut enough insulation away to make it possible to mount the bracket to the seat support panel. Refer to Fig. 1.

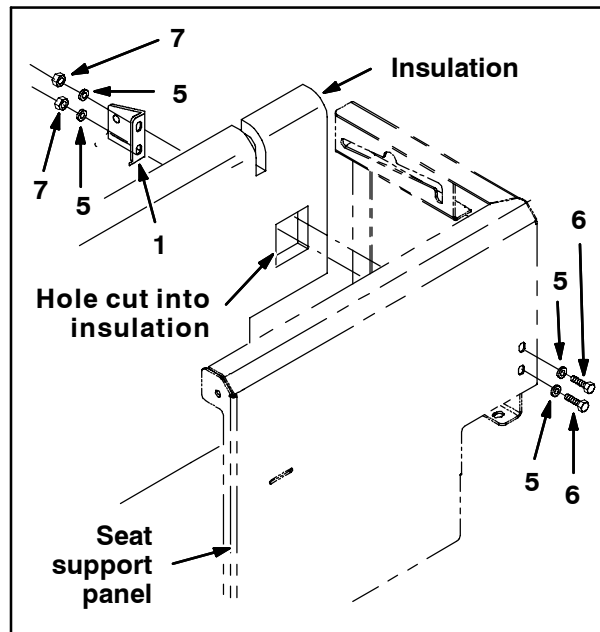

FIG. 1

3. Use two hex screws (6), four flat washers (5), and two hex nuts (7) to install the mounting bracket (1) onto the seat support panel. Refer to Fig. 1.

4. Drill two 11/32" through the top of the seat plate and the insulation under the seat plate. Refer to Fig. 5.

NOTE: It may be necessary to adjust seat position to make drilling holes into the seat plate weldment easier.

5. Hold a mounting bracket (1) against the insulation under the seat plate (where the two holes are drilled through the insulation) and cut enough insulation away to make it possible to mount the bracket to the seat plate. Refer to Fig. 2.

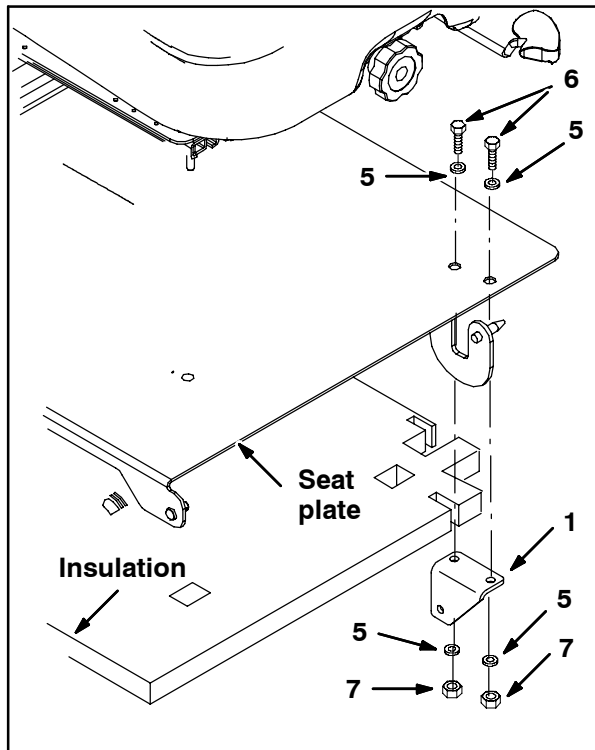

FIG. 2

6. Use two hex screws (6), four flat washers (5), and two hex nuts (7) to install the mounting bracket (1) onto the seat plate weldment. Refer to Fig. 2.

7. Use two ball studs (3) and two hex nuts (4) to install the gas spring (2) onto the mounting brackets (1) installed in the previous steps. Refer to Fig. 3 and Fig. 4.

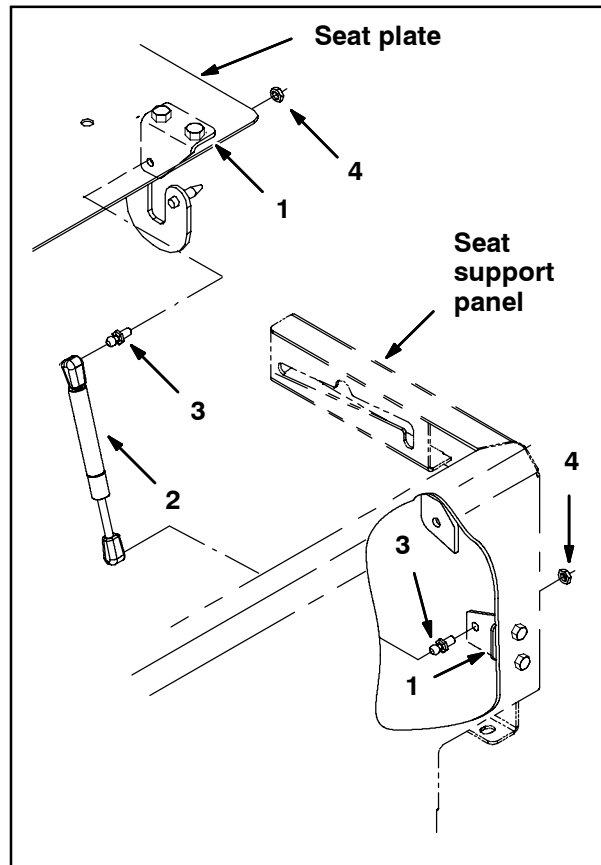

FIG. 3



FIG. 4

8. Open and close the operator seat/seat plate weldment to ensure the seat lift mechanism operates.

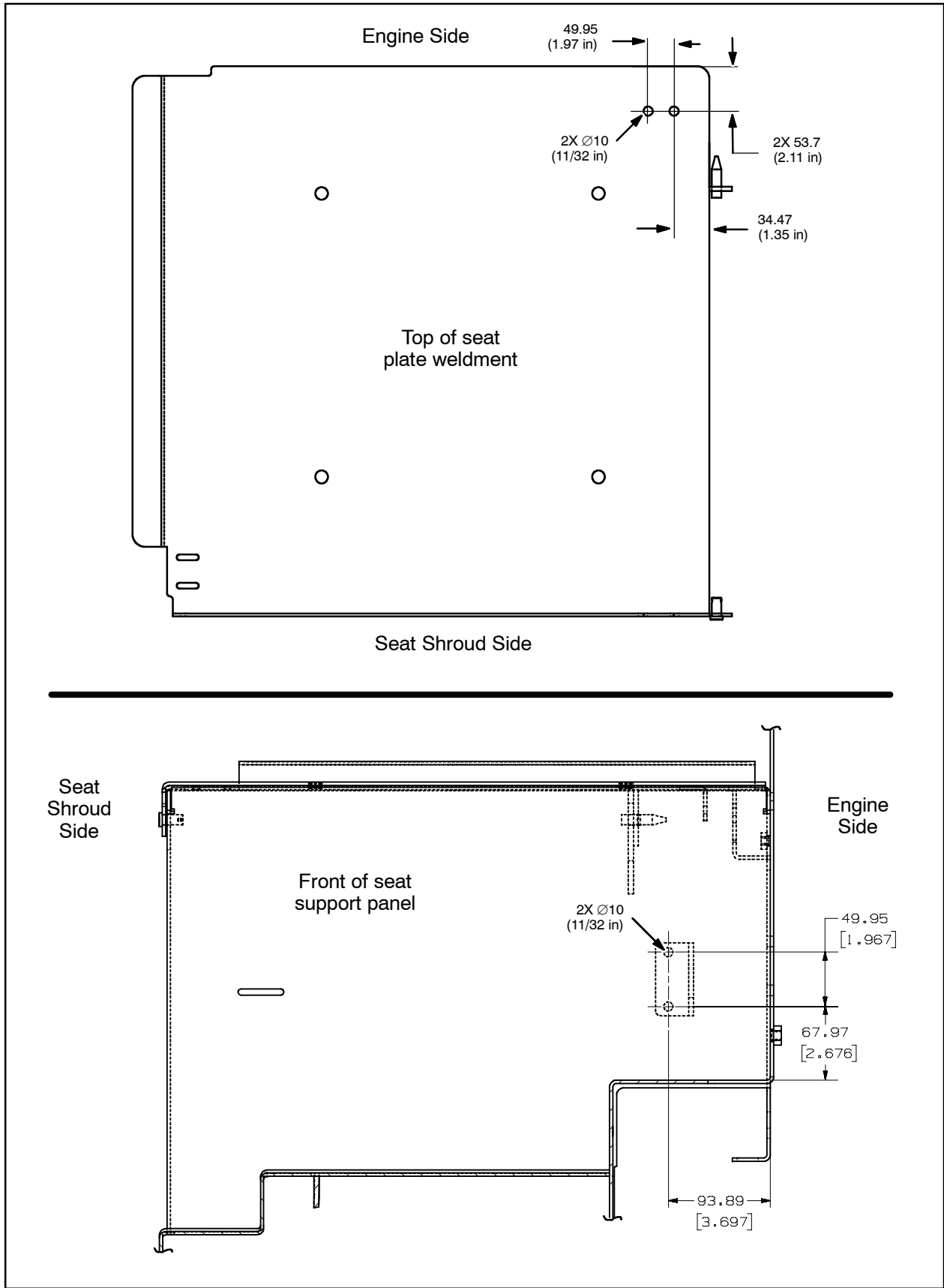

FIG. 5

Bill of Materials for Seat Kit, Lift, CI [M20 & T20]-9003283

	Ref.	Tennant Part No.	Description	Qty.
▽		9003283	Seat Kit, Lift, CI [M20 & T20]	1
▲	1	1034656	Bracket, Mtg	2
▲	2	368391	Gasspring, 175lb	1
▲	3	58494	Stud, Ball, .39D .31-16, Gasspring	2
▲	4	01760	Nut, Hex, Lock, .31-18, NL, SS	2
▲	5	01685	Washer, Flat, 0.38B 0.88D .08, SS	8
▲	6	09010	Screw, Hex, M8 X 1.25 X 25, SS	4
▲	7	08713	Nut, Hex, Lock, M8 X 1.25, NL, SS	4

TENNANT COMPANY
P. O. Box 1452
Minneapolis, MN 55440-1452